

CORYDON AVENUE

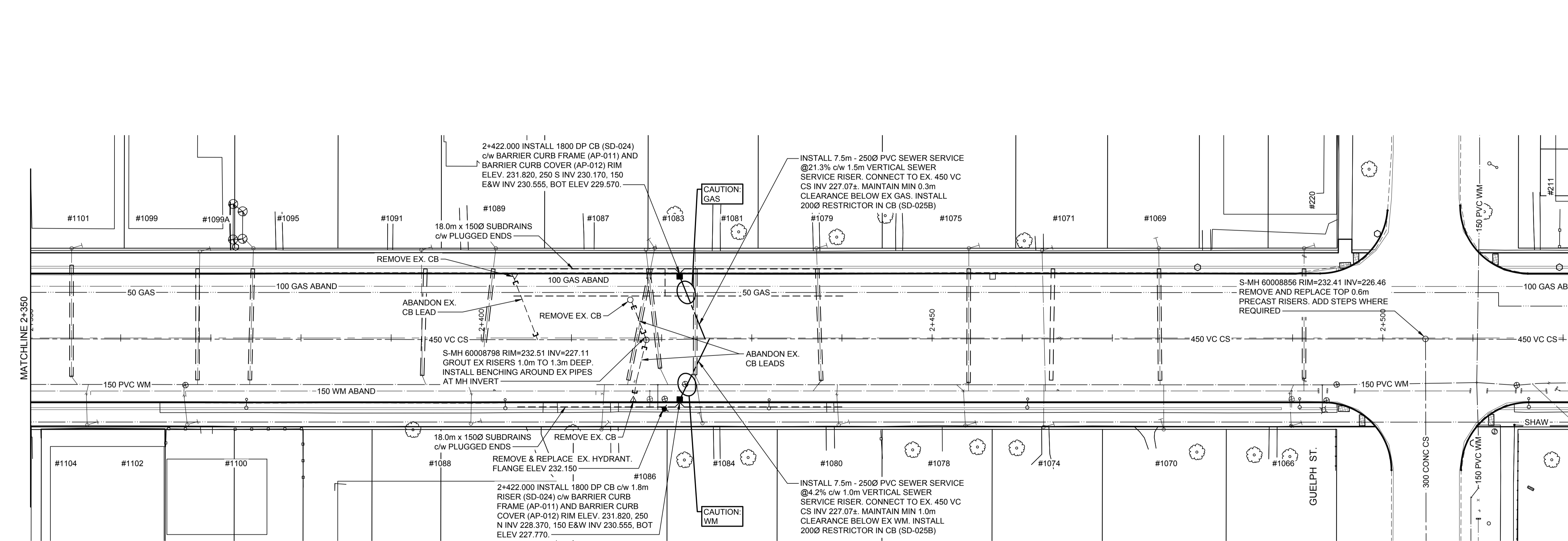
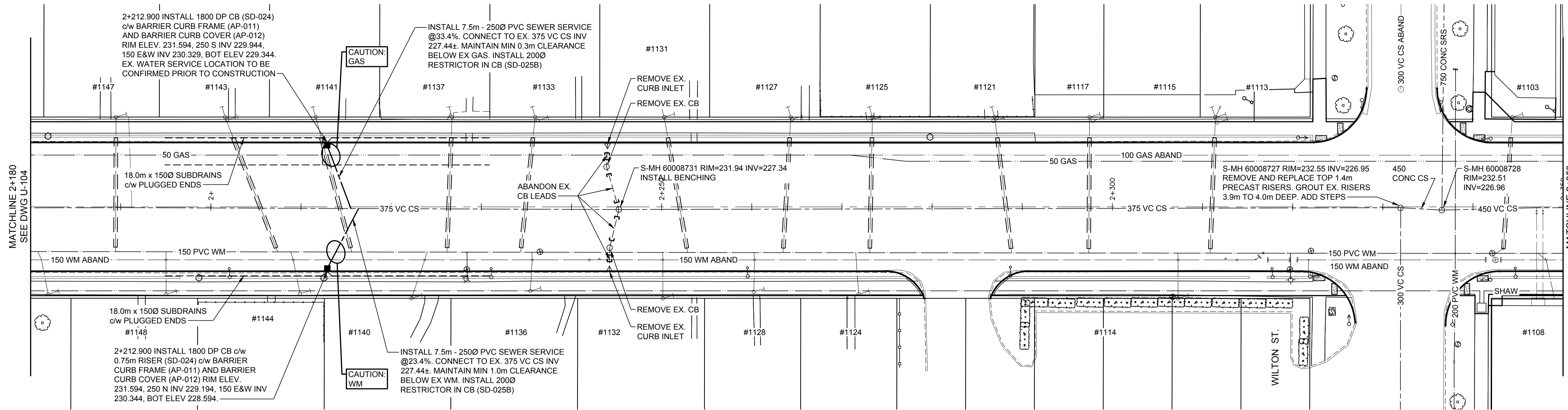

WARNING

IF POWER EQUIPMENT OR EXPLOSIVES ARE TO BE USED FOR EXCAVATION ON THIS PROJECT THE CONTRACTOR MUST:
 1) NOTIFY THE GAS COMPANY OF THE PROPOSED LOCATION OF EXCAVATION.
 2) TAKE PRECAUTION TO AVOID DAMAGE TO GAS COMPANY INSTALLATIONS.
 SEE PROVINCIAL REGULATION 140/92 FOR DETAILS

METRIC

WHOLE NUMBERS INDICATE MILLIMETRES
 DECIMALIZED NUMBERS INDICATE METRES

NOTES:

1. ADJUST MANHOLE RIMS AND GATE VALVES TO NEW GRADES.
2. CONTRACTORS TO CONFIRM THE LOCATION OF ALL UTILITIES/SERVICES IN THE FIELD PRIOR TO CONSTRUCTION.
3. CB OFFSETS ARE DIMENSIONS FROM CB CENTER TO B.O.C.
4. ALL NEW SEWER SERVICE PIPE TO BE TRENCHLESS INSTALLATION.

ALL LONG SIDE WATER SERVICES WITHIN THE LIMITS OF THE RECONSTRUCTION SHALL BE INSTALLED AS PER SPEC E-19
 PLAN: ————

**ENGINEERS
 GEOSCIENTISTS
 MANITOBA**
 Certificate of Authorization
 Stantec Consulting Ltd.
 No. 1301

150 WM	WATERMAIN	150 WM	HYDRO	150 WM			
HYDRANT	HYDRANT	150 WM	M.T.S.	CONCRETE			
VALVE	VALVE		CONCRETE	ASPHALT			
300 LDS	LAND DRAINAGE SEWER	300 LDS	SIDEWALK	MILL JOINT			
250 WWS	WASTE WATER SEWER	250 WWS	PROPERTY LINE	SURVEY BAR			
MANHOLE	MANHOLE		DITCH	ELEVATION	(31.334)	(32.231)	
CATCH BASIN	CATCH BASIN		ELEVATION	SIDEWALK RAMP			
CURB INLET/CATCH PIT	CURB INLET/CATCH PIT		LEGEND-PLAN	PROPOSED	EXISTING	LEGEND-PROFILE	PROPOSED
TRANSIT STOP	TRANSIT STOP						
CULVERT	CULVERT						
GAS	GAS						
EXISTING	LEGEND-PLAN	PROPOSED	EXISTING	LEGEND-PLAN	PROPOSED	EXISTING	LEGEND-PROFILE

LOCATION APPROVED UNDERGROUND STRUCTURES

SUPV. U/G STRUCTURES COMMITTEE	DATE
NOTE:	LOCATION OF UNDERGROUND STRUCTURES AS SHOWN ARE BASED ON THE BEST INFORMATION AVAILABLE BUT NO GUARANTEE IS GIVEN THAT ALL EXISTING UTILITIES ARE SHOWN OR THAT THE GIVEN LOCATIONS ARE EXACT. CONFIRMATION OF EXISTENCE AND EXACT LOCATION OF ALL SERVICES MUST BE OBTAINED FROM THE INDIVIDUAL UTILITIES BEFORE PROCEEDING WITH CONSTRUCTION.

B.M. ELEV.	
NO.	REVISIONS
DATE	BY
20.02.14	S.R.S.
2019/06/12	

Stantec
 500 - 311 Portage Avenue, Winnipeg MB Canada
 www.stantec.com

DESIGNED BY	R.S.	CHECKED BY	
DRAWN BY	W.A.	APPROVED BY	
HOR. SCALE:	1:250	RELEASED FOR CONSTRUCTION:	
VERTICAL:		DATE	

ENGINEER'S SEAL
PRELIMINARY DRAWING
 NOT TO BE USED FOR CONSTRUCTION
 CONSULTANT DRAWING NO.
U-105

THE CITY OF WINNIPEG
 PUBLIC WORKS DEPARTMENT
 ENGINEERING DIVISION

2019-2023 STAFFORD/TAYLOR/CORYDON
 TENDER 1
 CORYDON AVENUE
 WATERLOO STREET TO STAFFORD STREET
 UNDERGROUND INFRASTRUCTURE

SHEET 28 OF 55
 CAD FILE DRAWING NUMBER 08020u-101-932.dwg
 CITY DRAWING NUMBER P-3524-28